

Hanbury Manor, A Marriott Hotel & Country Club

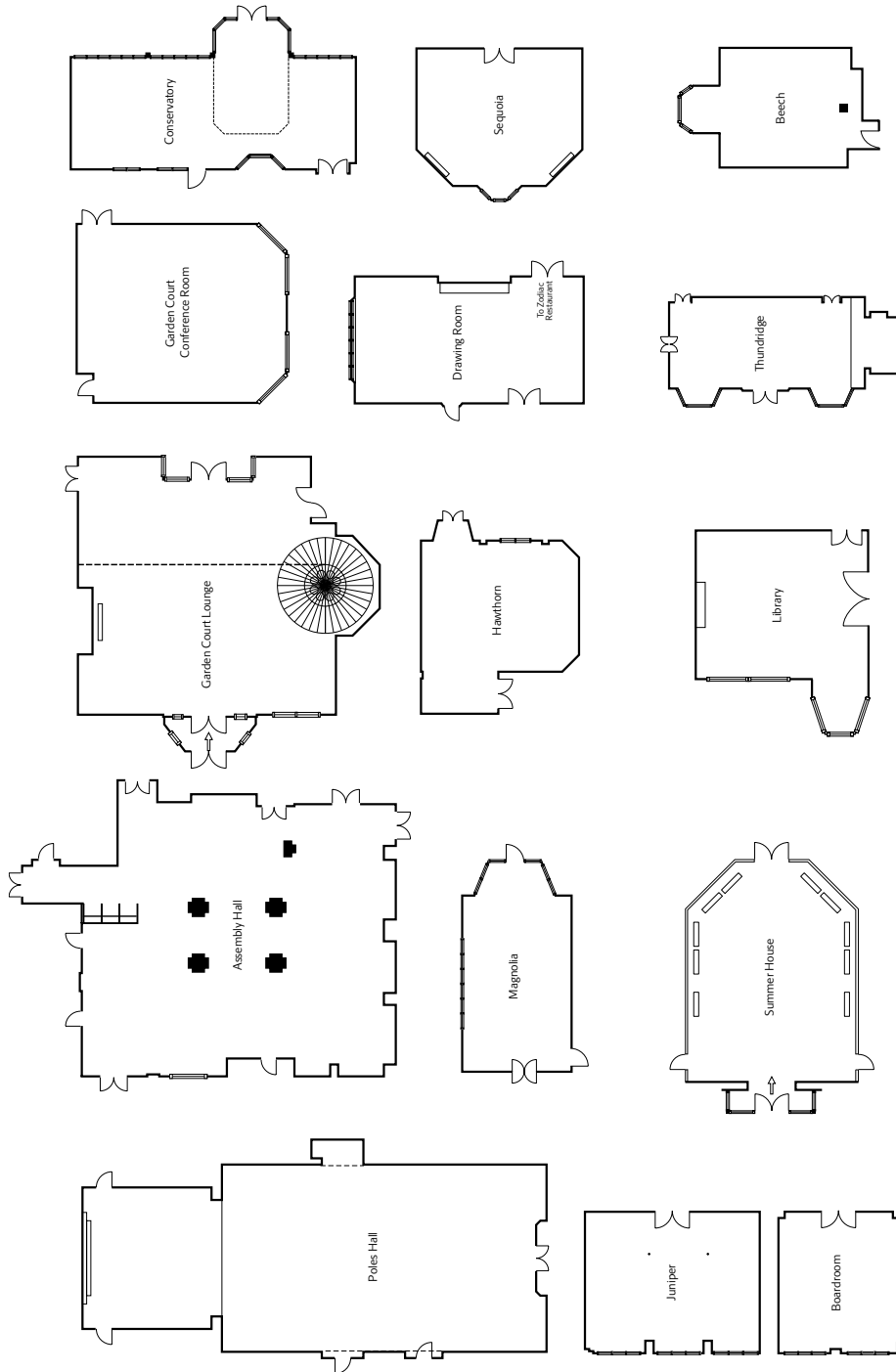

Scale: 1cm = 3 metres

With 14 impressive conference and meeting rooms, featuring beautiful period details such as rich oak panelling and open fireplaces, all equipped with the latest technology, this commanding location lends business events and social occasions distinction and prestige.



Hanbury Manor, A Marriott Hotel & Country Club

HANBURY MANOR, A MARRIOTT HOTEL & COUNTRY CLUB
 Ware, Hertfordshire SG12 0SD
 t: 44 (0) 1920 487 722 f: 44 (0) 1920 487 692
 MarriottHanburyManor.co.uk

Feel history surround you at Hanbury Manor, A Marriott Hotel & Country Club. This stately 17th century Jacobean style country house set in 200 acres of spectacular Hertfordshire parkland benefits from all the modern comforts associated with 5-star luxury. Within easy reach of Stansted, Heathrow, Luton and Gatwick airports, London and Cambridge, major rail and motorway links as well as numerous visitor attractions, this impressive hotel is close to everything that really matters.

Meeting Room	Natural Daylight	Air Conditioning	Wheelchair Access	Dimensions LxWxH (Metres)	Capacity												
					Theatre Style (No Projection)	Theatre Style (Back Projection)	Theatre Style (Front Projection)	Boardroom Style	U-Shape	Classroom Style	Cabaret Style (No Projection)	Cabaret Style (Back Projection)	Cabaret Style (Front Projection)	Buffet Reception	Dinner/Dance	Dinner	
Poles Hall	✓	✓	✓	15.5 x 8.8 x 17.4	100	100	80	40	40	80	80	80	80	80	120	100	120
Thundridge Room	✓	✓	✓	18.3 x 8.5 x 3.3	140	140	120	40	40	80	80	80	80	80	120	100	120
Hawthorne Room	✓	✓	✓	9.3 x 7.7 x 2.5	60	-	60	26	33	26	40	-	40	60	-	48	-
Magnolia Room	✓	✓	✓	10.3 x 5.4 x 3.3	40	-	40	21	24	18	24	-	24	40	-	30	-
Juniper Room	✓	✓	✓	8.3 x 6.7 x 2.5	30	-	30	20	16	18	24	-	24	30	-	30	-
Boardroom	✓	✓	✓	5.7 x 6.7 x 2.5	-	-	-	10	-	-	-	-	-	-	-	-	-
Garden Crt Conference Room	✓	✓	✓	9.9 x 8.5 x 2.3	50	-	50	20	24	26	40	-	40	40	-	-	-
Garden Crt Lounge	✓	✓	✓	12.3 x 12.2 x 2.3	80	-	80	30	36	48	60	-	60	120	80	80	80
Garden Crt Summer House	✓	✓	✓	10.9 x 8.4 x 7.7	-	-	-	-	-	-	-	-	-	-	-	-	-
Conservatory	✓	✓	✓	13.6 x 5.4 x 2.6	40	-	40	25	25	25	24	-	24	40	-	40	-
Drawing Room	✓	✓	✓	10.9 x 6 x 4.1	32	-	32	30	21	18	24	-	24	30	-	30	-
Sequoia Room	✓	✓	✓	8.1 x 6.7 x 2.5	25	-	25	24	21	18	24	-	24	30	-	36	-
Assembly Hall	✓	✓	✓	15.6 x 13 x 2.4	-	-	-	-	-	-	-	-	-	120	-	-	-
Beech Room	✓	✓	✓	6.09 x 5.67 x 2.65	20	-	15	10	9	9	16	-	16	20	-	10	-
Library	✓	✓	✓	9.0 x 6.16 x 5.0	30	-	20	20	15	-	-	-	-	30	-	20	-

ACCOMMODATION

Hanbury Manor features 161 traditionally elegant, spacious bedrooms with many period features. Premium guest rooms offer attractive views of the golf course or of the gardens. Marriott bedding package, featuring Egyptian cotton bedding, down mattress topper and duvets. Complimentary use of health club, romanesque pool, sauna, steam rooms, cardio & resistance gym. Well-defined area with desk, wireless internet access, laptop sized safe and LCD flat screen TV. Hanbury Manor offers an extensive in-room dining experience, with fresh and organic produce.

RESTAURANTS & LOUNGES

The Zodiac Restaurant: Classic British. Awarded 2 AA Rosettes for fine dining graciously served in an elegant setting. Open for dinner. Dress code: Shiny/Slacks

Oak Hall & Cocktail Bar: International. Rich wood panelling & open fire places create an ideal setting to relax. Indulge in the delights of afternoon tea from 2pm to 5pm, every day, or enjoy a pre-dinner cocktail or post dinner beverage in front of the open log fire. Open for lunch and dinner. Dress code: Casual.

Oakes Grill: International. Light and airy but with a warm and intimate feel, the bold colours & contemporary style enhance the relaxed and informal ambience, seating is also available on the year round terrace overlooking the 18th green. Open for breakfast, lunch and dinner. Dress code: Shiny/Slacks/Res.

MEETING FACILITIES

14 meeting rooms accommodating up to 140 people. Marriott Communication. Solutions in all conference rooms, high speed broadband internet connection. Areas available for team building and outdoor activities. LCD and plasma screens are available in all rooms in conference area.

RECREATION & LEISURE

Indoor romanesque swimming pool, on-site spa, jacuzzi, sauna & steam. Cardiovascular equipment & extensive gym facilities. Creche available for babies to 8 year olds at a charge.

ATTRACTIONS

Paradise Wildlife Park, Cambridge University, Hatfield House, Knebworth House, Oxford University, St Albans Abbey, Duxford Imperial War Museum, Woburn Safari Park, London Eye

GOLF FACILITIES

18-hole Championship golf course, driving range, practice ground and short game area.

PARKING

Complimentary parking on-site

DIRECTIONS

From London area: Leave M25 at J25 and take A10 northbound towards Hertford. Remain on A10 for 12 miles, then take the A1170 exit marked Wadesmill & Thundridge. Turn right at the roundabout and the hotel is immediately on your left.

From North on A10: Take A1170 exit marked Wadesmill & Thundridge. Turn left at the first roundabout and continue straight over the next roundabout and the hotel is immediately on your left.

By Rail: The nearest mainline station is Ware which is approximately 10 minutes journey time from the hotel. **By Air:** London Stansted Airport - 30 Minutes; London Luton Airport - 48 Minutes; London Heathrow Airport - 54 Minutes; London Gatwick Airport - 1hour 20 mins